

CORPORATE OVERVIEW

ADH Technical Services, Inc. dba ADH Environmental (ADH) is a California Corporation established in 1999. As an environmental consulting services corporation, ADH's staff is comprised of storm water and surface water quality management professionals, professionally certified engineers, professional geologists, engineering geologists, qualified SWPPP developers and practitioners, hydrogeologists, oceanographers, biologists, and database management personnel. ADH staff have up to 30 years of experience in serving both public and private sector clients.

ADH's staff includes 10 full- and over 20 part-time employees and reputable independent professional associates who have devoted their time and energies to the success of ADH. ADH's corporate offices are located in Soquel, California, with regional offices located in Trinidad, Redding and Napa. ADH is a very nimble corporation able to provide our services throughout central and northern California for a broad spectrum of work ranging from small/routine projects to large/high profile projects requiring an elevated degree of business and technical sophistication.

ADH is certified as an 8(a) and a Small Disadvantaged Business (SDB) by the U.S. Small Business Administration, as a Disadvantaged Business Enterprise (DBE) by the California Unified Certification Program (Caltrans), as a Minority Business Enterprise (MBE) by the California Public Utilities Commission, and as a Micro Business (MB) by the California Department of General Services. Therefore, in addition to providing superior professional services, ADH can assist our clients in meeting important diversity supplier contractual requirements.

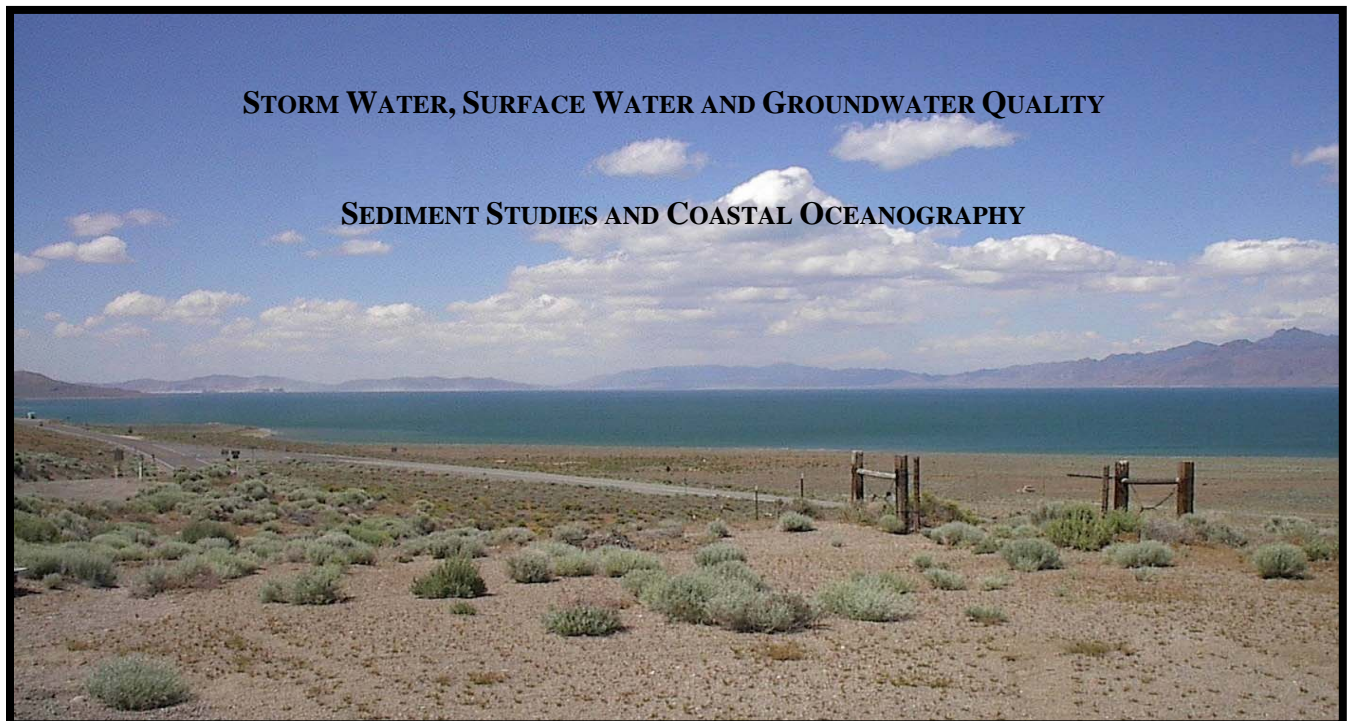

MISSION STATEMENT

To provide our clients the highest quality professional consulting services based upon a sound strategic approach, thorough analyses and effective solutions.

NAICS CODES AND DESCRIPTIONS



541620

Environmental Consulting Services

541690

Other Scientific Consulting Services

541990

Other Professional Scientific and Technical Services

541380

Environmental Testing Laboratory or Services

562910

Hazardous Waste Treatment and Disposal
Remediation Services

518210

Data Processing Hosting or Related Services

SERVICES

Storm Water, Surface Water and Groundwater Quality

- NPDES I and II Regulatory Compliance
- Stormwater Monitoring Program Design
- Stormwater Pollution Prevention Plans, Implementation, Inspections and Reporting
- Stormwater Compliance Audits
- Erosion and Sediment Control
- Best Management Practice (BMP) Efficacy Testing
- MS4 and CSO Characterization Monitoring and Reporting
- Stormwater and Water Quality Monitoring Data Reports
- Monitoring Site Selection
- Special Runoff Studies
- Remotely Operated Monitoring Equipment Installation, Operation, and Maintenance
- Field Operations and Logistics
- Sediment and Receiving Waters Monitoring
- Freshwater and Marine Biological Indicators Sampling and Assessment
- Groundwater Sampling, Characterization and Reporting
- Statistical Analysis of Water Quality Data

Sediment Studies and Coastal Oceanography

- Dredge Material Re-use / Disposal Studies
- In-situ Water Quality Monitoring
- Vibracore Sediment Sampling
- Surficial Sediment and Water Quality Sampling
- Boat and Barge Operations
- Long Tube Column Settling Testing
- Geotechnical Construction Support, Testing Investigations and Reporting
- Sediment Transport Modeling
- Current Metering and CTD Profiling
- Buoy/Mooring Design and Deployment
- Dye Dilution Studies
- Intertidal /Subtidal Biological Assessments
- Bioaccumulation Studies
- Benthic Community Analysis
- Soil Sampling and Characterization

STORM WATER AND SURFACE WATER QUALITY SERVICES

ADH has successfully executed storm water and water quality monitoring programs since 1999. In addition, many of our professional staff have over twenty years of experience performing municipal, industrial, transportation corridor, commercial, and federal water quality projects. ADH staff has performed such projects throughout California, Arizona, Nevada, Hawaii, Oklahoma, and Texas. These programs have been conducted in compliance with industrial, construction and municipal National Pollutant Discharge Elimination System (NPDES) I and/or II requirements, and other pertinent receiving water quality criteria. ADH staff experience cover a wide range of expertise related to storm water and surface water quality management including, but not limited to the following:

- Preparation and implementation of Storm Water Pollution Prevention Plans (SWPPPs) and Sampling and Analysis Plans (SAPs)
- Literature reviews and feasibility studies
- Quality Assurance Project Plans (QAPPs), and monitoring reports
- Design, installation, maintenance and operation of flow-weighted and time-based remote monitoring and sampling stations
- Innovative sampling techniques for dry weather flow, illicit discharge detection, special runoff studies and tidally influenced outfall sampling programs
- Municipal separate storm sewer system (MS4) and combined sewer overflow (CSO) monitoring
- NPDES ocean-outfall receiving waters monitoring
- Wet weather and dry season observations and reporting
- Stream rating



Grab sampling for volatile organic compounds to assess presence of petroleum based constituents in surface water.

- Construction General Permit SWPPP site inspections
- Industrial SWPPP facilities inspections
- Prepare training manuals and conduct classroom and in-the-field storm/surface water quality sampling and monitoring training
- Quality Assurance and Quality Control

BMP EXPERIENCE:

Storm water best management practices (BMP) program experience have included evaluation of pollutant removal capabilities of natural and constructed landscaped features and manmade treatment systems by evaluating and/or incorporating certain management practices, or the installation and testing of engineering control devices (BMPs) as presented below:

- Storm Water Pollution Prevention Plan (SWPPP) BMP investigation, evaluation, revision and implementation
- Storm water detention basin design
- Industrial facilities sediment control BMPs design and implementation
- BMP efficacy testing of a storm water separator
- Open and/or Gap Graded Asphalt Pavements (OGAP) water quality study
- Ornamental Roadside Vegetated Treatment Study (ORVTS)
- Stormwater bioretention BMP water quality study



Specialized flow measurement and sampling station coupled with highly experienced staff to ensure valid BMP effectiveness testing.

SEDIMENT STUDIES AND COASTAL OCEANOGRAPHY SERVICES

ADH provides professional capabilities and expertise in environmental and physical oceanographic studies as detailed below. ADH staff has performed such studies for both governmental and private sector clients at various locations throughout California. ADH staff has experience providing technical expertise, evaluation and development of many aspects related to the following:

- Dredge Material Reuse/Disposal Option(s) Study Design
 - Sediment Transport Modeling
 - Sand Mining
- Dye Studies
- Current Metering Studies
- Ocean Observatories
 - Buoys
 - Moorings
- Sampling and Analysis Plans (SAPs)
- Quality Assurance Project Plans (QAPPs)
- Boat and Barge Operations
 - Research Vessels
 - Support Vessels
- Dredge Material Sampling (On-and Off-shore)
 - Vibracoring
 - Gravity Coring
 - Drilling
 - Grab (Smith/Mac, VanVeen, and Box Core)
- Subsurface Soil Sampling, Characterization and Reporting
- Elutriate Sample Collection
- In-situ Water Quality Monitoring
 - Conductivity, Temperature, Depth, pH and Dissolved Oxygen (CTD) Profiling
 - Light Transmissivity Profiling
 - Vacuum Interceptor Pump System
 - At Depth Discrete Sampling
- Long-tube Column Settling Testing, Data Analysis and Reporting
- Dredge Material Reuse/Disposal Evaluations
 - Analytical Chemistry, Modified Elutriate Test, Modified Waste Extraction and Toxicity Data
 - ADDAMS Modeling
 - Sediment Budgets
 - Ocean, In-Bay, Upland Reuse and/or Disposal

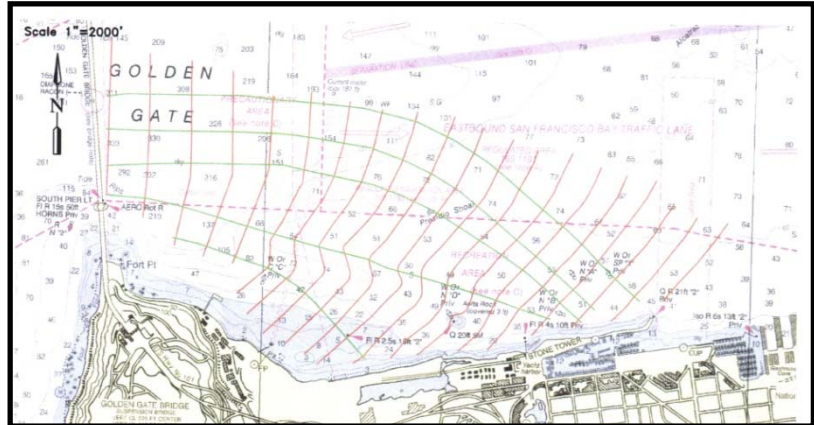

Illustration, as excerpted from SAIC and ADH report, *San Francisco Marina West Basin, Sand Deposition Conceptual Model*, July 6, 2006, that show ocean wave patterns incoming to the San Francisco Marina breakwater depositing sand by littoral longshore drift to the east along the Marina West Basin breakwater and entrance channel.



Shore-based water sampling data is used to model dye dilution in the receiving water.



Vibracore sediment samples are collected for characterization of deposited materials to determine reuse and/or disposal options.

KEY STAFF

ALESSANDRO D. HNATT

President/CEO
B.A., Physical Geography, 1984
A.S., Commercial Pilot, 1981

CHRISTIAN KOCHER

Vice President of Operations
Senior Scientist
Graduate Studies in Oceanography
B.S., Physics, 1988

JACK BETOURNE, CPESC, QSD

Napa Regional Manager
Certified Profess. Erosion and Sediment Control
Qualified SWPPP Developer/ Practitioner
B.S., Forest Management, emphasis in
Watershed Science, June, 1980

BARRY KELLER, PH.D., P.G., C.H.G.

Senior Hydrogeophysicist
Professional Geologist, California
Certified Hydrogeologist, California
Ph.D., Geophysics, 1984
M.S., Geophysics, 1978
B.S., Geology, 1969

DAVID SKINNER, CESSWI, QSP

Redding Regional Manager
Certified Erosion, Sediment and Stormwater
Inspector
Qualified SWPPP Practitioner
Caltrans 24 hour SWPPP Preparer
Active Treatment System (ATS) Operator
M.B.A., Business Administration, May, 2011
B.S., Small Bus. Entrepreneurship, June, 2009
A.A., General Education, June, 2006

DUNCAN GEDDES, P.G., C.E.G., QSD

Senior Engineering Geologist
Professional Geologist, California
Certified Engineering Geologist, California
Qualified SWPPP Developer/ Practitioner
M.S., Earth Science/Geology, 1992
B.S., Earth Science/Geology, 1989

TIM COOK, P.E., P.G., C.E.G., QSD

Senior Engineer
Professional Civil Engineer, California
Professional Geologist, California
Certified Engineering Geologist, California
Qualified SWPPP Developer/ Practitioner
M.S., Geological Engineering, 1985
B.A., Geology, 1976

STEEN TRUMP, QSP

Trinidad Regional Manager
Project Biologist
Qualified SWPPP Practitioner
B.A., Marine Biology, 1992

DUSTIN MILLER, CPSWQ, CPESC, QSD

Sediment and Erosion Control Specialist
Certified Professional Stormwater Quality
Certified Profess. Erosion and Sediment Control
A.S., Natural Sciences, June, 2010

LUCILE PAQUETTE

Project Manager
M.S., Resource Mgmt. and Conservation, 2009
B.S., Geology, 2006
A.S., Horticulture, 2004

PETER WILDE

Senior Information Technologist
B.A., Physics and Information Sciences, 1979

CALVIN SANDLIN

Senior Staff Geologist
B.S., Earth Science, 1996

LOWELL COTTLE

Senior Staff Biologist
B.S., Environmental Geography, 1998

KEVIN LEWIS

Staff Geologist
B.S., Earth Science, 2007

CLIENT TESTIMONIALS

“As project manager for the California Department of Transportation’s Environmental Engineering Assistance Task Order for the Devil’s Slide Improvement Project, I am familiar with the work of ADH Environmental, who provided subcontractor support services to Brown and Caldwell for that project... In response to these unique challenges, ADH Environmental demonstrated thorough knowledge and capabilities in their specialized areas of expertise. ADH Environmental has consistently provided timely responsiveness, often under challenging conditions, and they have routinely proved their capacity to successfully implement and complete work products on time, within budget, and to our client’s satisfaction.”

Mike Flake, PE
Project Manager
Brown and Caldwell
May, 2009

“I wanted to thank you and the staff of ADH Environmental for continued technical and field support on environmental service projects under Science Applications International Corporation (SAIC) contract with the City and County of San Francisco (City) Department of Public Works. ADH’s technical expertise and responsive services aided in the successful completion of the San Francisco Marina West Basin Sediment Characterization Study and securing long term dredge program permits. I also appreciate the excellent field service support the ADH team provided during pre dredge sediment characterization studies completed on Berth 35East/West on behalf of the Port of San Francisco.”

Kathryn Purcell
Program Manager
Science Applications International Corporation
March, 2008

“...ADH Environmental (ADH) has been providing outstanding and unique - especially among Disadvantaged Business Enterprise firms - expertise in storm water management services to MACTEC Engineering and Consulting, Inc. (MACTEC) since 2005. ADH provides expertise in project oversight and management, technical guidance and consultation; development and/or review of deliverable documentation such as Guidance Manuals, Sampling and Analysis Plans, Technical Memorandums, Technical Data Reports; and, storm water field services incorporating state-of-the-art monitoring equipment and telecommunications.”

Jay Shrake
Caltrans Task Order Manager
MACTEC Engineering and Consulting, Inc.
March, 2008

“Their services are highly recommended and endorsed by the Summit Lake Paiute Tribe as reliable and dedicated to their clients needs. They go out of their way to find the answer or response to your questions. In the last three + years; it has been an outstanding affiliation.”

Robyn Burdette
Tribal Chairwoman
Summit Lake Paiute Tribe
March, 2006

CONTACT INFORMATION

To learn more about ADH Environmental, or to request a proposal on your project, please contact:

SOQUEL OFFICES:

ALESSANDRO D. HNATT
PRESIDENT
3065 PORTER STREET, SUITE 101
SOQUEL, CA 95073
Tel.: (831) 477-2003
Cell: (831) 535-2211
Fax: (831) 477-0895
Email: adh@adhenvironmental.com

TRINIDAD OFFICES:

STEEN TRUMP
REGIONAL MANAGER
411 WESTHAVEN DRIVE
TRINIDAD, CALIFORNIA 95570
Tel.: (707) 822-1778
Cell: (707) 834-4499
Email: strump@adhenvironmental.com

BUSINESS DEVELOPMENT:

STEPHEN MEACHAM
BUSINESS DEVELOPMENT DIRECTOR
3065 PORTER STREET, SUITE 101
SOQUEL, CA 95073
Tel.: (831) 477-2003
Cell: (707) 980-5433
Fax: (831) 477-0895
Email: smeacham@adhenvironmental.com

REDDING OFFICES:

DAVID SKINNER
REGIONAL MANAGER
2310 CHRISTIAN AVENUE
REDDING, CALIFORNIA 96002
Tel: (530) 242-1533
Cell: (530) 524-2633
Email: dskinnner@adhenvironmental.com

STORM WATER & WATER QUALITY:

CHRISTIAN KOCHER
VICE PRESIDENT
3065 PORTER STREET, SUITE 101
SOQUEL, CA 95073
Tel.: (831) 477-2003
Cell: (831) 295-3242
Fax: (831) 477-0895
Email: ckocher@adhenvironmental.com

NAPA OFFICES:

JACK BETOURNE
REGIONAL MANAGER
4335 CHABLIS DRIVE
NAPA, CALIFORNIA 94558
Tel.: (707) 258-1388
Cell: (707) 637-3881
Email: jbetourne@adhenvironmental.com

Website: <http://www.adhenvironmental.com>